

GREG MISAKYAN
6277 VAN NUYS BLVD SUITE 118
VAN NUYS, CA, 91401
Tel: (818) 374-1300
Fax: (818) 374-1347
E-Mail: GMmoderndesign@gmail.com

Owner:
6940 Longridge Ave
North Hollywood, CA 91605

Project Name:
NEW S.F.D.
W/ ATTACHED GARAGE

Project Address:
6940 Longridge Ave
North Hollywood, CA 91605

Scale: 1/4"=1'-0"

DRAWN BY: GREG MISAKYAN
DRAWN BY:
JOB NUMBER: 000-2018
PRINT DATE: 6/18/2018
SHEET NO:

A-2

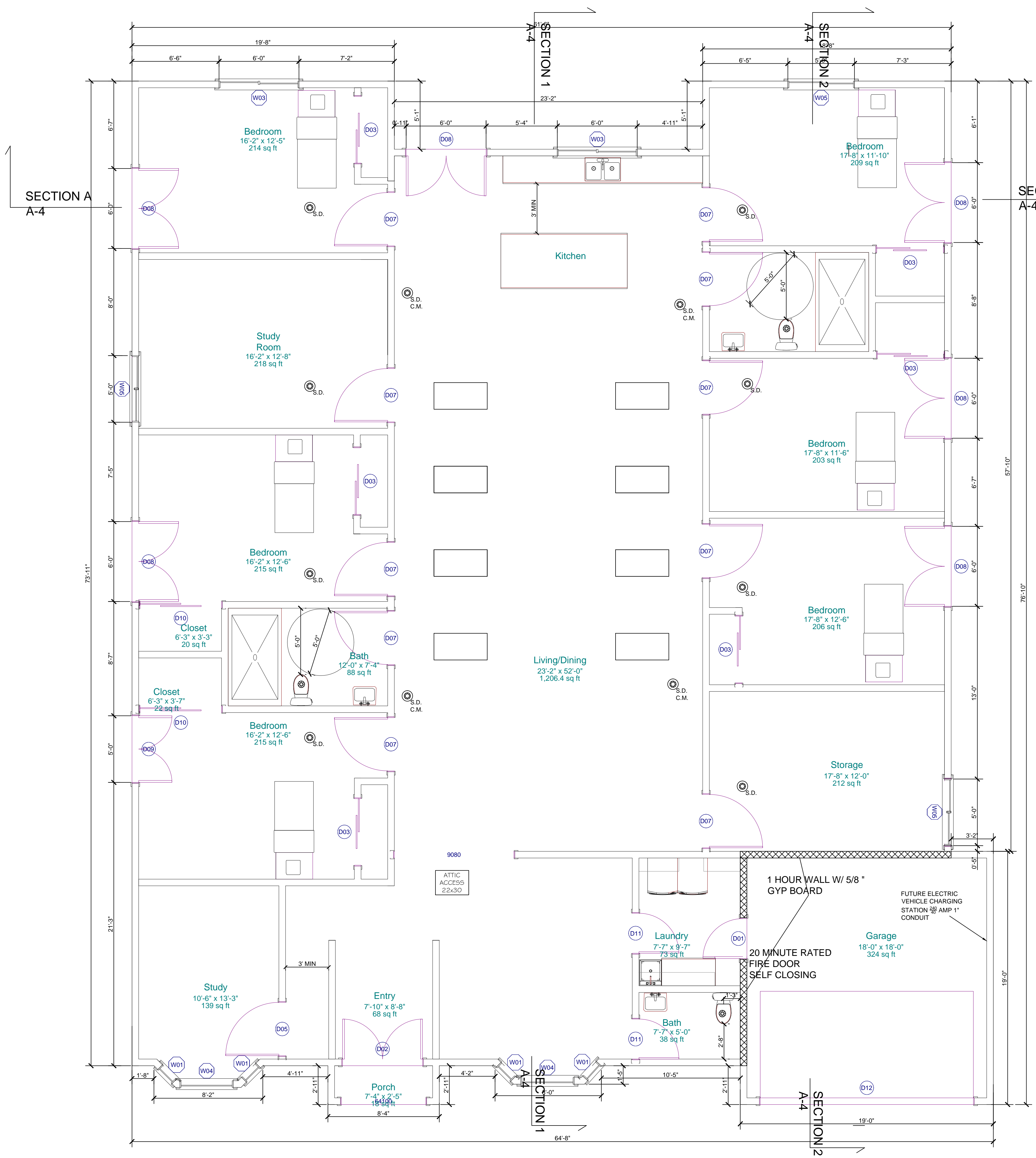

Door Schedule							
Number	Qty	Dimensions	Height	R/O	Description	Header	Thickness
D01	2	36"x80"x1 3/4"	80"	37"x81 1/2"	ext. Hinged-Glass	4x4x40"	1 3/4"
D02	1	72"x108"x1 3/4"	108"	73"x109 1/2"	ext. Double Hinged-Glass	4x8x76"	1 3/4"
D03	10	60"x80"x1 3/8"	80"	61"x81 1/2"	Slider-Slab	4x6x64"	1 3/8"
D05	1	48"x80"x1 3/8"	80"	49"x81 1/2"	Hinged-Slab	4x6x52"	1 3/8"
D06	2	32"x96"x1 3/8"	96"	33"x97 1/2"	Hinged-Slab	4x4x36"	1 3/8"
D07	10	48"x96"x1 3/8"	96"	49"x97 1/2"	Hinged-Slab	4x6x52"	1 3/8"
D08	6	72"x96"x1 3/4"	96"	73"x97 1/2"	ext. Double Hinged-Glass	4x8x76"	1 3/4"
D09	2	72"x96"x1 3/4"	96"	73"x97 1/2"	ext. Double Hinged-Glass	4x6x64"	1 3/4"
D10	2	72"x80"x1 3/8"	80"	74 3/8"x81 1/2"	Slider-Slab	4x8x77 3/8"	1 3/8"
D11	2	36"x80"x1 3/8"	80"	37"x81 1/2"	Hinged-Slab	4x4x40"	1 3/8"
D12	1	192"x96"x1 3/4"	96"	193"x97 1/2"	Garage-Garage Door P03	4x8x196"	1 3/4"
D13	4	36"x96"x1 3/8"	96"	37"x97 1/2"	Hinged-Slab	4x4x40"	1 3/8"

Window Schedule								
Number	Qty	Dimensions	Width	Height	R/O	Description	Header	Egress
W01	4	18"x60"	18"	60"	19"x61 1/2"	Single Casement	4x4x22"	
W02	1	48"x48"	48"	48"	49"x49 1/2"	Right Sliding	4x6x52"	
W03	5	72"x60"	72"	60"	73"x61 1/2"	Right Sliding	4x8x76"	
W04	2	48"x60"	48"	60"	49"x61 1/2"	Fixed Glass	4x6x52"	
W05	6	60"x60"	60"	60"	61"x61 1/2"	Right Sliding	4x6x64"	
W06	1	72"x24"	72"	24"	73"x25 1/2"	Right Sliding	4x8x76"	

- LEGEND**
- NEW WALLS
 - 1 HOUR WALL WITH TYPE 5/8" GYP BOARD
 - HARD WIRED SMOKE DETECTOR W/ BATTERY BACK-UP
 - MECHANICAL VENT. 50 CFM AIR CHANGE PER HOUR. ENERGY STAR HUMINISTAD SENSOR DIRECTLY TO THE OUTSIDE
 - 12" X 12" TUB ACCESS
 - DRYER VENT, DIRECTLY TO OUTSIDE MUST BE 1/2" OR LESS
 - WATER HEATER
 - BALCONY DRAIN PER DETAIL
 - GROUND- FAULT CIRCUIT-INTERUPTER
 - EXIT SIGN WITH BATTERY BACK UP POWER
 - ATTIC ACCESS 22x30
 - 2X4 SKYLIGHT by "VELUX" OPENABLE ICC #25885

PROPOSED FLOOR PLAN
SCALE: 1/4" = 1'-0"